

PRODUCT
CATALOGUE

PT. Jaya Sentosa

IKM Building 5th Floor

Jl. Daan Mogot no. 6

Jakarta Barat - 10460

Indonesia

Phone : +6221 5697 0831

Fax : +6221 5697 0841





PT Jaya Sentosa Valvindo is one of the leading stockiest, wholesaler and sole agent for various kinds of valves. We supply and distribute various types of valves & accessories products not only to Indonesia industry, but also to overseas countries. Our company is specialized in all sorts of industrial supply. We supply Industrial valves that offer reliability, high endurance, parts inter-changeability, ease of maintenance

COMPANY PROFILE

With our Board of Director experience for selling valves and accessories more than 10 years, we believe we can supply your needs with correct product, high quality product and competitive price and backed up by professional modernized technicians.

We warmly welcome customers to consulting and negotiate with us.

Thank you and regards,
PT. Jaya Sentosa Valvindo



One Piece Ball 1000 W.O.G / PN 63

SANKYO

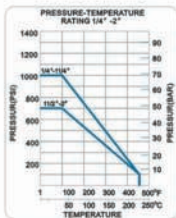

Features :

- ✓ Pipe thread in accordance : NPT, BSPT, DIN259, DIN2999, ISO 228 Class A
- ✓ Blow-out proof stem/full port
- ✓ Investment casting body
- ✓ 1000 PSI (PN63) W O G
- ✓ Locking device

Material :

- ✓ S45C/ASTM A216Gr-WCB/DIN 1.0619
- ✓ S5316/ASTM A315Gr-CF8M/DIN 1.4408

Dimensions :

SIZE		d	L	H	W	CV FACTOR	TORQUE N.M	WEIGHT
DN	NPS							
6	1/4"	5	39	34	68	4	0.6	0.07
10	3/8"	7	44	36	80	4	0.9	0.11
15	1/2"	10	59	47	95	4.5	1	0.18
20	3/4"	13	60	50	95	9	2	0.26
25	1"	16	72	52	114	16	4	0.39
32	1-1/4"	20	77	57	114	24	5.5	0.59
40	1-1/2"	25	84	67	156	37	7	0.82
50	2"	32	100	73	156	68	9	1.23

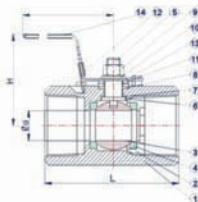

Material List :

NO	PART NAME	MATERIAL	
1	BODY	WCB	CF8M
2	CAP	WCB	CF8M
3	BALL	CF8M	
4	SEAT	PTFE	
5	STEM	S5316	
6	GASKET	PTFE	
7	THRUST WASHER	PTFE	
8	PACKING	PTFE	
9	STEM NUT	S5304	
10	SPRING WASHER	S5305	
11	PACKING RING	S5306	
12	LOCKING DEVICE	S5307	
13	HANDLE	S5308	
14	PLASTIC COVER	PLASTIC	



Features

- ✓ FACE TO FACE DIMENSION: JIS B2002 / ANSI B16.10
- ✓ END FLANGE DIMENSION: JIS B2239 / ANSI B16.5
- ✓ DESIGN: ANSI B16.34
- ✓ TEST: API 598
- ✓ INVESTMENT CASTING BODY

Dimensions :

SIZE	d	L	H	D		C		G		T		
				10K	150	10K	150	10K	150	10K	150	
1/2"	15	15	112	65	85	70	60.5	52	35	12	11.1	
3/4"	20	20	125	70	100	98	75	70	56	14	11.1	
1"	25	25	135	75	125	108	90	79.5	70	14	11.1	
1-1/2"	40	40	165	107	140	127	105	98.5	85	16	14.3	
2"	50	50	203	120	155	152	130	120.5	100	16	15.9	
2-1/2"	65	65	216	135	175	178	140	139.5	120	18	17.5	
3"	80	80	241	147	185	190	150	152.5	130	127	18	19.1
4"	100	100	292	169	210	229	175	190.5	155	157	18	23.9
5"	125	125	330	190	250	254	210	216	185	186	20	23.9
6"	150	150	356	213	280	279	240	241.5	215	216	22	25.4
8"	200	200	495	253	330	343	290	298.5	265	270	22	28.6
10"	250	250	622	279	400	406	335	362	325	324	14	30.2
12"	300	300	698	312	445	483	400	432	370	381	24	31.8

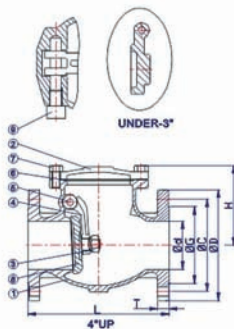

Test Pressure :

SHELL (BY WATER)		450PSI
		32kg/cm ²
SEAT		
BY WATER		315PSI
		22kg/cm ²
BY AIR		80PSI
		6kg/cm ²

Material List :

NO	PART NAME	MATERIAL	
1	BODY	A126CLB	A216WCB
2	BONNET	A126CLB	A216WCB
3	NUT	A194-2H	
4	ARM HINGE	A126CLB	A216WCB
5	HINGE PIN	S5304	
6	GASKET	NON ASBSESTOS	
7	BOLT	A193-B7/A194-2H	
8	DISK	A126CLB	A216WCB
9	BOLT	S5304	



Features :

- ✓ PIPE THREAD IN ACCORDANCE: NPT, BSPT, DIN259, DIN2999, ISO228 CLASS A CLASS 200 W O G
- ✓ INVESTMENT CASTING BODY
- ✓ INSIDE SCREW AND SCREWED BONNET
- ✓ WEDGE DISC, INTEGRAL SEAT

MATERIAL:

- ✓ SS316/ASTM A351
- ✓ Gr-CFRM/ DIN 1.4408

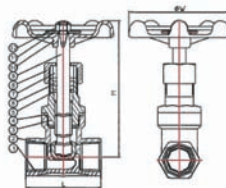

Dimensions :

SIZE	NPS DN	1/4"	3/8"	1/2"	3/4"	1"	1-1/4"	1-1/2"	2"
		L	6	10	15	20	25	32	40
H	52	52	52	66	76	86	94	118	
W	105.5	105.5	107	116	129.2	153.5	157	172	
WEIGHT/KGS	70	70	70	80	80	90	100	100	
	0.338	0.32	0.329	0.472	0.66	1.01	1.29	1.822	

Material List :

NO	PART NAME	MATERIAL
1	BODY	CF8M
2	DISK	CF8M
3	BONNET	CF8M
4	GASKET	PTFE
5	GASKET	SUS 304
6	PACKING	PTFE
7	GLAND	SS304
8	CAP NUT	SS316
9	STEM	SS316
10	HANDLE	ALUMINIUM
11	NAME PLATE	ALUMINIUM
12	STEM NUT	SUS304



Features :

- ✓ SINGLE DOOR TYPE
- ✓ FLANGE: ANSI-#150/#300
DIN-PN16/25/40
- ✓ FACE TO FACE: DIN3202-K4
- ✓ PRESSURE: 800PSI (PN40) FOR W.O.G.
- ✓ TEMP: -60°F TO 800°F

MATERIAL:

- ✓ SS316/ASTM A351
- ✓ Gr-CF8M/DIN 1.4408

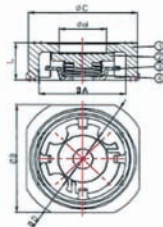

Material List :

NO	PART NAME	MATERIAL
1	BODY	CF8M
2	DISK	CF8M
3	SPRING DISC	SUS316
4	SP RING	SUS316

Dimensions :

SIZE	NPS	1/2"	3/4"	1"	1-1/4"	1-1/2"	2"	2-1/2"	3"	4"	5"
	DN	15	20	25	32	40	50	65	80	100	150
	d	15	20	25	32	38	50	62	77	96	136
	A	35	42	46.2	61	70.5	80	100	112	135	197
	B	45	55	65	79	89	99	118	134	154	216
	C	43	53	57	74	82	91	112.5	125	149	216
	D	53	63	73	84	94	107	126	144	164	220
	L	16	19	22	28	32	40	46	50	60	106
	WEIGHT/KGS	0.1	0.16	0.28	0.52	0.7	1.1	1.58	1.76	3.3	9.82

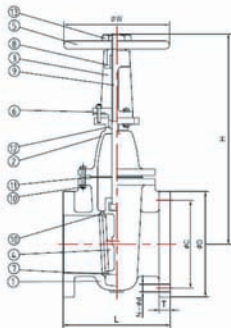

Material List :

NO	PART NAME	MATERIAL	
1	BODY	A126-CLB	A216-WCB
2	BONNET	A126-CLB	A216-WCB
3	YOKE	A126-CLB	A216-WCB
4	DISC	A126-CLB	A216-WCB-13Cr
5	HANDWHEEL	A126-CLB	FCD 400
6	GLAND FLANGE	FCD 450	A216-WCB
7	SEAT RING	BRASS	A105+13Cr
8	YOKE SLEEVE	BRASS	A439-D2
9	STEM	S5 416	A182 F6a
10	BONNET BOLTS/NUIT	A193 B7 / A194 2H	
11	GASKET	NON AS BEST OS SWG	
12	PACKING	NON AS BEST OS GRAPHITE	
13	WHEEL NUT	A126-CLB	A194-2H
14	NAME PLATE	ALUMINIUM	



Test Pressure :

SHELL (BY WATER)	450PSI	
	32kg/cm ²	
SEAT	BY WATER	315PSI
	BY AIR	229kg/cm ²
		80PSI
		6kg/cm ²

Dimensions :

SIZE	d	L	H	W	D		C		G		T		
					10K	150	10K	150	10K	150	10K	150	
2"	50	50	178	320	200	155	152	120	120.5	96	92	16	15.9
3-1/2"	65	65	190	375	200	175	178	180	188.5	116	105	18	17.5
3"	80	80	203	445	250	185	190	150	152.5	126	127	18	19.1
4"	100	100	229	525	250	210	229	175	190.5	151	157	18	23.9
5"	125	125	254	606	300	290	254	210	216	182	186	20	23.9
6"	150	150	267	710	300	280	279	240	241.5	212	216	22	25.4
8"	200	200	292	910	350	330	343	290	298.5	262	270	22	28.6
10"	250	250	330	1117	400	400	406	355	362	324	324	24	30.2
12"	300	300	356	1324	400	445	483	400	432	368	381	24	31.8

Features :

- ✓ FACE TO FACE DIMENSION: JIB2002 / ANSI B16.10
- ✓ END FLANGE DIMENSION: JISB2239 / ANSI B16.5
- ✓ DESIGN: ANSI B16.34
- ✓ TEST: API 598
- ✓ INVESTMENT CASTING BODY

GLOBE VALVE

10K /150LB FLANGE END



Dimensions :

SIZE	d	L	H	W	D		C		G		T		
					10K	150	10K	150	10K	150	10K	150	
1/2"	15	15	108	168	140	95	89	70	60.5	51	35	12	11.1
3/4"	20	20	117	168	140	100	98	75	70	56	43	14	11.1
1"	25	25	127	173	140	125	108	90	79.5	67	51	14	11.1
1-1/4"	32	32	140	190	160	135	117	100	89	76	64	16	12.7
1-1/2"	40	40	165	200	160	14	127	105	98.5	81	73	16	14.3
2"	50	50	203	230	200	155	152	120	121	96	92	16	15.9
2-1/2"	65	65	216	243	200	175	178	140	140	116	105	18	17.5
3"	80	80	241	286	250	185	190	150	153	126	127	18	19.1
4"	100	100	292	325	250	210	229	175	191	151	157	18	23.9
5"	125	125	356	380	300	250	254	210	216	182	186	20	23.9
6"	150	150	406	445	350	280	279	240	242	212	216	22	25.4
8"	200	200	495	545	350	330	343	190	299	262	270	22	28.6
10"	250	250	622	650	400	400	406	355	362	324	324	24	30.2
12"	300	300	698	736	400	445	483	400	432	368	381	24	31.8

Features :

- ✓ FACE TO FACE DIMENSION: JISB2002 / ANSI B16.10
- ✓ END FLANGE DIMENSION: JISB2239 / ANSI B16.5
- ✓ DESIGN: ANSI B16.34
- ✓ TEST: API 598



Material List :

NO	PART NAME	MATERIAL	
1	BODY	A-126 CLB	A216 WCB
2	BONNET	A-126 CLB	A216 WCB
3	STEM	SS 416	A182 F6a
4	DISC	FCD 450	A216 WCB+13Cr
5	SEAT RING	BRASS	A 105+13Cr
6	GASKET	NON ASBESTO 5	SWG
7	BOLT & NUT	A193 B7 / A194 2H	
8	GLAND PACKING	NON ASBESTO 5	Graphite
9	GLAND	FCD 450	A216 WCB
10	HANDWHEEL	CASTIRON	DUCTILE IRON
11	NAME PLATE	ALUMINIUM	

Test Pressure :

SHELL (BY WATER)		450PSI
		32kg/cm ²
SEAT		
BY WATER		315PSI
		22kg/cm ²
BY AIR		80PSI
		6kg/cm ²

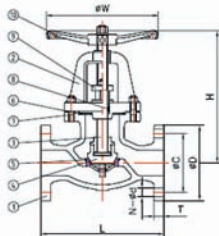



Features :

- ✓ FACE TO FACE DIMENSION: JIS B2002/ANSI B16.10
- ✓ END FLANGE DIMENSION: JIS B2239/ANSI B16.5
- ✓ DESIGN: ANSI B16.34
- ✓ TEST: API 598
- ✓ INVESTMENT CASTING BODY

Material List :

NO	PART NAME	MATERIALS		
1	BODY	WCB	SCS13	SCS14
2	CAP	WCB	SCS13	SCS14
3	GASKET	PTFE		
4	SCREEN	SS304		
5	BONNET BOLT	ASRE194-88/A194-2H		
6	STOPPER	SS304		

Dimensions :

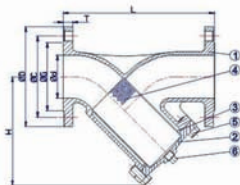

Screen Specification :

SIZE	PERFORATION
1/2" - 1-1/4"	1.5 MM
1-1/2" - 10"	2MM

SIZE	d	L	H	D		C		G		T		
				10K	150	10K	150	10K	150	10K	150	
1/2"	15	15	120	75	95	89	70	60.5	52	35	12	11.1
3/4"	20	20	140	75	100	98	75	70	58	43	14	11.1
1"	25	25	150	100	125	108	90	70.5	70	51	14	11.1
1-1/2"	40	40	190	120	140	127	105	98.5	85	73	16	14.3
2"	50	50	210	140	155	152	120	121	100	92	16	15.9
2-1/2"	65	65	250	175	175	178	140	140	120	105	18	17.5
3"	80	80	280	196	185	190	150	153	130	127	18	19.1
4"	100	100	340	244	210	229	175	191	155	157	18	23.9
5"	125	125	380	277	250	254	210	216	185	186	20	23.9
6"	150	150	420	320	280	279	240	242	215	216	22	25.4
8"	200	200	500	390	330	343	290	299	265	270	22	28.6
10"	250	250	730	508	400	406	355	362	325	324	24	30.2

Test Pressure :

SHELL	BY WATER	450PSI 33kg/cm ²
	BY AIR	80PSI 6kg/cm ²

AV (AUTO VALVE)

Pneumatic Electric Actuator



Material List :

Part No.	Qty/SET	Part name	Standard Material	Selected Material
1	1	Left End Cap	Die-Casting Aluminium -Alloy	Stainless steel
2	1	Right End Cap	Die-Casting Aluminium -Alloy	Stainless steel
3	1	Cylinder	Die-Casting Aluminium -Alloy	Stainless steel
4	2	Piston	Die-Casting Aluminium -Alloy	-----
5	1	Output Shaft	Carbon Steel	Stainless steel
6	1	Adjustmen Cam	Stainless Steel	-----
7*	2	O-ring (End Cap)	NBR	Fluorine or silicone rubber
8*	2	O-ring (Piston)	NBR	Fluorine or silicone rubber
9*	1	O-ring (Bottom of Output Shaft)	NBR	Fluorine or silicone rubber
10*	1	O-ring (Top of Output Shaft)	NBR	Fluorine or silicone rubber
11*	2	O-ring (Adjusting Screw)	NBR	Fluorine or silicone rubber
12*	2	Plug (Cylinder)	NBR	Fluorine or silicone rubber
13*	2	Bearing (Piston)	Nylon 46	-----
14*	1	Bearing (Top of Output Shaft)	Nylon 47	-----
15*	1	Bearing (Bottom of Output Shaft)	Nylon 48	-----
16*	1	Guid Bearing (Piston Back)	Nylon 49	-----
17*	2	Thrust Bearing (Output Shaft)	Nylon 50	-----
18	2	gasket (Output Shaft)	Stainless Steel	-----
19	1	Flexible Stop Ring	Spring Steel	-----
20	4	Cap Bolt	Stainless Steel	-----
21	4	Cap Gasket	Stainless Steel	-----
22	2	Gasket	Stainless Steel	-----
23	2	Nut	Stainless Steel	-----
24	2	Adjustmen Bolt	Stainless Steel	-----
25	2	Guide Block	Nylon 66 +30%FG	-----
26	5-12	Spring Component	Alloy Spring Steel	-----
27	1	Position	Polypropylene PP+30%GF	-----
28	1	Indicating Screw	Plastic	-----



Double Acting Operating Diagram

Selection of Double-Acting Actuators

The suggested safety factor for double-acting actuators under normal working condition is 20%-30%

For Example : - Valve Torque = 100 N.m

- Safety Factor Torque = $100 \times (1+30\%) = 130 \text{ N.m}$

- Air Supply = 5 Bar According to double-acting torque table, minimum model AT-125 can be selected.

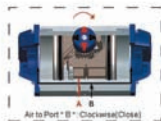

Torque Diagram :

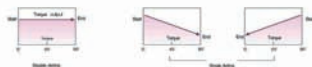



Pneumatic Electric Actuator AV (AUTO VALVE)



Material List :

No	PART NAME
1	Case Body
2	Opening Mete
3	Inlet Wire Lock
4	Rubber Cover of Handle Shaft
5	No-Bracket Installation
6	Gear Box Cover
7	Electric Cover
8	Wiring Cover
9	Handle Shaft Cover
10	Output Shaft
11	Adapter

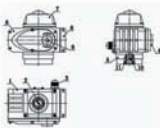

Performance Parameter of Modulating Type :

Model	AV-05A	AV-10A	AV-20A	AV-40A	AV-60A	AV-100A	AV-200A
Power	DC24V/AC24V,AC110V,AC220V,AC380V,50/60HZ						
Performance	DC24V/AC24V,AC110V,AC220V,AC380V,50/60HZ						
Motor Power (W)	15W	25W	40W	90W	90W	100W	100W
Rated Current (A)	0.24A	0.32A	0.88A	1A	1A	1.2A	1.2A
	(AC220V)	(AC220V)	(AC220V)	(AC220V)	(AC220V)	(AC220V)	(AC220V)
Output Torque (N.m)	50Nm	100Nm	200Nm	400Nm	600Nm	1000Nm	2000Nm
Motion Time (S)	20s	30s	30s	30s	45s	50s	100s
Rotary Angle (°)	0-360°		0-90°				
Input Signal	4-20mA.DC, 1-5V.DC, 0-10V.DC (others could be set before delivery)						
Output Signal	4-20mA.DC (others could be set before delivery)						
Precision Grade	1%						
Weight	2.7 kg	4.3 kg	9.3 kg	10 kg	10 kg	11.2 kg	11.8 kg
Voltage Resistance	DC24V:500VAC/1min				1500VAC/1min		
Insulation Resistance	DC24V:100MΩ/300VDC				100MΩ/500VDC		
Protection Class	IP-68						
Ambient Temp.	-30° C~+60° C						
Installation Angle	360-Degree Optional Direction						
Case Body Material	Die-Casting Aluminium Alloy						
Optional Function	I.Over Torque Protectors II. Dehumidify Heater						

Testing Pressures

Shell tightness: 1,5 times the allowable pressure at room temperature.

Seat tightness: 1,1 times the allowable pressure at room temperature.

Maximum allowable seat leakage

The criteria for seat leakage of JSV soft sealing gate valves is Rate A: no Visually detectable leakage for the duration of the test ("zero drops")

Pressures and temperatures

- up to 25 kg/cm² (PN6, 10/16 and 25)/
- from -10°C up to 80°C.

Quality Control

- 100% of JSV soft sealing gate valves are tested according to EN 12166-1, DIN 3230, or as per customer requirements.
- According to EN 1074 (2.500 cycles endurance resistance).

Features

- Full bore.
- Complete water tightness.
- Free maintenance.
- Low operating torque values.
- According to ISO, INE, DIN NF, BS and AWWA standards.

Scope

- Potablewater, sewage, seawater,
- HVAC or compressed air.
- Industrial processes.
- Irrigation
- Fire protection
- Vacuum



Minimum test duration (in seconds)

Nominal Diameter DN	Shell	Seat
Up to DN50 included	15	15
From DN65 up to DN200 (both included)	60	15
From DN250 up to DN 450 (both included)	180	30
DN500 and above	180	60

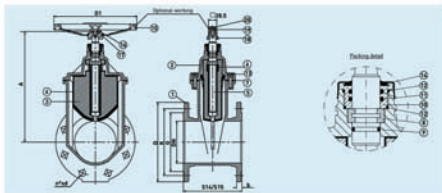

Dimensions :

DN	D	b	EN 1092-2 PN 10			EN 1092-2 PN 16			EN 558 (DIN 3202)		Weight kg		A	D1	No. of turns for closing
			K	G	N x d	K	G	N x d	S14 (F-4)	S15 (F-5)	S14 (F-4)	S15 (F-5)			
40	150	19	110	84	4x19	110	84	4x19	140	240	8	9	192	125	10
50	165	19	125	99	4x20	125	99	4x20	150	250	10	11	202.5	125	12.5
65	185	19	145	118	4x21	145	118	4x21	170	170	12.5	13.5	233	150	13
80	200	19	160	132	4x22	160	132	8x19	180	280	17	18.5	268	175	16
100	220	19	180	156	8x19	180	156	8x20	190	300	21	22.5	310	200	20
125	250	19	210	184	8x20	210	184	8x21	200	325	29.5	32	357.5	250	25
150	285	19	240	211	8x21	240	211	8x23	210	350	38	41	398.5	300	30
200	340	20	295	266	8x22	295	266	12x23	230	400	58	66	488.5	350	33.3
250	400	22	350	319	12x23	355	319	12x28	250	450	85.5	100.5	541.5	400	45
300	455	24.5	400	370	12x24	410	370	12x28	270	500	121	141	654.5	500	50
*300	520	26.5	460	429	16x23	470	429	18x28	290	550	144	166	656.5	500	50

* Base dimension 300mm

Material List :

Item	Name	No. Pieces	Material	Standard
1	Body	1	EN-GJ-500-7 (GGG-50)	EN 1563
2	Bonnet	1	EN-GJ-500-7 (GGG-50)	EN 1564
3	Wedge	1	EN-GJ-500-7 (GGG-50)	EN 1585
4	Wedge coating	1	EPDM	EN 681 - 1
5	Stem	1	X20 Cr 13	EN 10080
6	Wedge lock nut	1	Copper alloy	EN 12165
7	Body bonnet gasket	1	EPDM	681 - 1
8	Fix washer	1	Copper alloy	EN 12165
9	O-ring (stem)	1	EPDM	EN 681 - 1
10	Stuffing nut	1	Copper alloy	EN 12165
11	O-ring (stuffing nut)	2	NBR	ASTM D2000
12	O-ring (s.nut / bonnet)	2	NBR	ASTM D2000
13	Body bonnet bolt	ac/DN	B.8 steel (GEOMET coated)	DIN 912
14	Dust guard	1	EPDM	
15	Handheel	1	Stamped steel	
16	Handheel bolt	1	X 5 CrNi 18 10	EN 10080
17	Handheel washer	1	X 5 CrNi 18 10	EN 10080
18	Square cap	1	EN-GJ-500-7 (GGG-50)	EN 1563
19	Square cap bolt	1	X 5 CrNi 18 10	EN 10088
20	Square cap top	1	Lupolen	

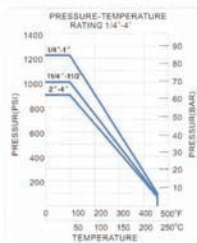

Features :

- ✓ Pipe thread in accordance : NPT, BSPT, DIN259, DIN2999, ISO 228 Class A
- ✓ Screwed end/socket/butt weld end
- ✓ Blow-out proof stem/full port
- ✓ Investment casting body
- ✓ 1000 PSI (PN63) W.O.G
- ✓ Locking device

Material :

- ✓ S45C/ASTM A216Gr-WCB/DIN 1.0619
- ✓ SS316/ASTM A315Gr-CF8M/DIN 1.4408

Dimensions :

SIZE		d	L	H	W	C	S	CV FACTOR	TORQUE NUM	WEIGHT KG
DN	NPS									
6	1/4"	11.6	58	52	102	40.5	14.1	6	4.2	0.37
10	3/8"	12.7	58	54	102	40.5	17.6	7	4.2	0.34
15	1/2"	15	63	62	123	47	21.7	10	7	0.51
20	3/4"	20	73	66	123	53.5	27.1	25	9	0.66
25	1"	25	85	77	153	59.6	33.8	35	12.4	0.96
32	1 1/4"	32	96	80	153	74.2	42.6	46	15	1.5
40	1 1/2"	38	114	91	183	84	48.7	80	20	2.2
50	2"	50	134	98	183	101	61.1	110	30	3.32
65	2 1/2"	65	180	138	246	132	76.9	310	42	7.21
80	3"	80	200	149	246	162	89.8	360	65	12.58
100	4"	100	228	175	246	191	116	820	100	19.6

Material List :

NO	PART NAME	MATERIAL	
1	BODY	WCB	CF8M
2	CAP	WCB	CF8M
3	BALL	CF8M	
4	SEAT	PTFE	
5	STEM	SS316	
6	HEX NUT	SS304	
7	THRUST WASHER	PTFE	
8	PACK	PTFE	
9	GLAND	SS304	
10	SPRING WASHER	SS305	
11	STEM NUT	SS306	
12	LOCKING DEVICE	SS307	
13	HANDLE	SS308	
14	PLASTIC COVER	PLASTIC	
15	BOLT WASHER	SS304	

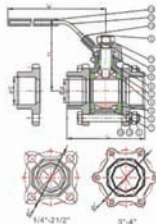



Since 1973, first thermoplastic valves manufacturer in Taiwan, SH has been specializing in the R&D, and production of valves and pipes. For the past 30 years, we've been in the lead in products quality with state-of-the-art technology and process. Our products, sold in more than 40 countries worldwide, are extensively used and applied in a wide variety of piping system, gaining a good reputation as a reliable supplier.

SH people, committed to the five beliefs all the time—HONESTY, RELIABILITY, RESPONSIBILITY, COURTESY AND HONOUR—working together as responsible and reliable team, are led by a group of resilient and determined leaders, and dedicated to design, innovation, and quality increase with business growth. In order to ensure high quality products. We have been successfully certified by NSF (American National Sanitation Federation), Lloyd's and BSI quality assurance.

Based on the belief in providing more complete products line and one-stop-shopping service, we continued to expand our products line in a variety of sizes to meet customers' needs for a complete line of pipes by developing new materials, such as UPVC, CPVC, PP, HD-PE, ABS, and PVDF, and bringing in advanced extrusion equipment and techniques from Austria and Germany, respectively, we have become one of the leading manufacturers in the world with the most complete line of thermoplastic valves, fittings, and pipes and the widest variety of materials.

Self-encouraged SH people are always in pursuit of excellence for the sole purpose of total customer satisfaction, besides, you are always welcome at our company at any time and we prize your highly valued opinions. We continue to be devoted to the R&D and innovation in this industry to win customer approval and receive customer compliments.





Thermoplastic Butterfly Valve

SH



Dimensions :

Nom. Size DN-inch	JSV													Unit = mm		Working Press (kg/cm ²)
	D1	D2	D3	Ø e	n	L	L1	H1	H2	H3	I	K	Test Press (kg/cm ²)			
													Body	Seal		
50-2"	57	120	160	19	4	35	42	83	102	68	250	220	15	12	10	
65-2 1/2"	72	140	184	19	4	37	46	92	110	68	270	220	15	12	10	
80-3"	80	150	200	19	8	37	46	100	118	68	286	220	15	12	10	
100-4"	100	175	230	19	8	47	56	115	134	68	317	220	15	12	10	
125-5"	130	210	250	23	8	57	66	127	160	96	318	310	15	12	10	
150-6"	150	240	290	23	8	62	71	145	177	96	418	310	15	12	10	
200-8"	203	290	337	23	12	76	87	168	204	93	465	414	15	12	10	

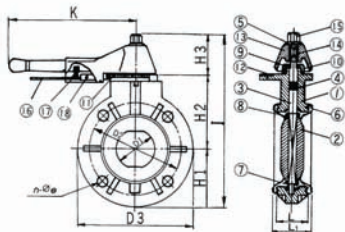

Material List :

Item	Part	Pcs	Materials	Item	Parts	Pcs	Materials
1	Body	1	UPVC,PP,PPG,PVD	10	Retainer cap	1	UPVC,PP
2	disc	1	UPVC,PP,PPG,PVD	11	Positioner	1	SUS304 8" Use SS41
3	Stem	1	SUS410,SUS316	12	Screw	3	SUS304
4	Stem O'ring	2	EPDM VITON	13	Handle	1	A85
5	Washer	1	SUS304	14	Inserted Heatal of Handle	1	FD0208
6	Seat	1	EPDM VITON	15	Nut	1	PVC COATED BRASS, SUS304
7	Disc O'ring(1)	2	EPDM VITON	16	Handle Lever	1	SUS 304 8" USE SS41
8	Disc O'ring(2)	2	EPDM VITON	17	Spring	1	SUS304
9	Stem Retainer	1	SUS304	18	Set pin	1	B58M



JSV Rotary Floating Shoe valves provide unmatched performance as airlocks in high wearing applications. This Rotary Floating Shoes can last up to four times longer than traditional rotary valves.

THE TOUGHEST AIRLOCK OR METERING SOLUTION FOR HIGH WEARING PRODUCTS

Rotary Floating Shoe or RFS Valves form an important part of the JSV Product range of materials handling valves. RFS Valves are rotary valves specifically designed for high wear applications.

The valves can be used in both positive and negative pressure applications and consist of a main body with bolt-on side plates and a rotating, webbed rotor located in between.

Opening Size	: 250 to 750 mm
Flange Opening	: Circular / Square
Differential Pressure	: Higher Pressure handling capability
Temperature	: Build to eminent Temperature
Drives	: Direct Driven / Chain Driven
Material of Construction	: Mild Steel / Cast Iron / Stainless Steel
Capacity Range	: upto 550 m ³ /hr Max.

Technology

To achieve 100% positive sealing, the JSV RFS Series Valve has a "FLOATING SHOE" which slides tightly into the main body top port flange and rides onto the rotor by gravity force. The shoe slide is sealed with a double 'O' ring between the shoe and the main body, and where the shoe rides on the rotor, the contact surface between the two parts forms a mechanical seal.

Features

The JSV RFS Series also feature a sacrificial, hardened SG iron adjustable shoe. The shoe, which sits on the rotor, has up to 10mm of wear and can be adjusted externally while in operation to maintain minimal clearance at all times.

- Ultra heavy duty cast iron.
- Ceramic tipped rotor to ceramic tipped rotor to improve wear.
- Adjustable hardened cast iron shoe to maintain airlock even after some wear has occurred.
- Available in direct drive or chain drive.
- Easy to maintain.
- Build to eminent temperature.
- Higher pressure handling capability.
- Heavy duty cast iron construction
- Available in a range of speeds



Long Service Life

The long service life that distinguishes JSV RFS valves from all other valves in the market is achieved through the ceramic tips embedded in all leading surfaces of the blades and end plates of the rotor.

Applications

JSV Rotary Floating Shoe Series Valve offers up to 4 times the life of a standard Rotary valve offering unparalleled value for high wearing products such as Alumina, iron ore, cement, coal, fly-ash and mineral sands.

RFS series valves are designed to require very little maintenance over their service life. JSV can offer an overhaul service for customers in which out of service RFS valves can be returned and re-conditioned for return to the client. This minimises the spare parts inventory required by the customer as well as the on-site training required. For customers who rather carry out their own maintenance JSV stocks a comprehensive range of spares available for quick turnaround.

Material List :

DN	Torque (Nm)
40	20
50	20
65	30
80	40
100	40
125	60
150	70
200	90
250	170
300	180
350	310
400	350
*450	350
500	450
600	500
*700	500
800	2400
*900	2400
1000	3600
*1200	3600

*Reduce Bore to DN 400, 600, 800, 1000mm.

Item	Name	No. Pieces	Material	Standard
1	Body	1	EN-GJS-500-7 (GGG-50)	EN 1563
2	Bonnet	1	EN-GJS-500-7 (GGG-50)	EN 1564
3	Wedge	1	EN-GJS-500-7 (GGG-50)	EN 1565
4	Wedge coating	1	EPDM	EN 681 - 1
5	Stem	1	X20 Cr 13	EN 10080
6	Wedge lock nut	1	Copper alloy	EN 12165
7	Body bonnet gasket	1	EPDM	681 - 1
8	Fix washer	1	Copper alloy	EN 12165
9	O-ring (stem)	1	EPDM	EN 681 - 1
10	Stuffing nut	1	Copper alloy	EN 12165
11	O-ring (stuffing nut)	2	NBR	ASTM D2000
12	O-ring (s.nut / bonnet)	2	NBR	ASTM D2000
13	Body bonnet bolt	acc/DN	8.8 steel (GEOMET coated)	DIN-912
14	Dust guard	1	EPDM	
15	Handwheel	1	Stamped steel	
16	Handwheel bolt	1	X 5 CrNi 18 10	EN 10080
17	Handwheel washer	1	X 5 CrNi 18 10	EN 10080
18	Square cap	1	EN-GJS-500-7 (GGG-50)	EN 1563
19	Square cap bolt	1	X 5 CrNi 18 10	EN 10088
20	Square cap top	1	Lupolen	

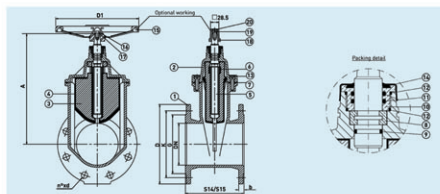

Dimensions :

DN	D	b	EN 1092-2 PN 10			EN 1092-2 PN-16			EN 558 (DIN 3202)		Weight kg		A	D1	No. of turns for closing
			K	G	N x d	K	G	N x d	S14	S15	S14	S15			
									(F-4)	(F-5)	(F-4)	(F-5)			
40	150	19	110	84	4x19	110	84	4x19	140	240	8	9	192	125	10
50	165	19	125	99	4x20	125	99	4x20	150	250	10	11	202.5	125	12.5
65	185	19	145	118	4x21	145	118	4x21	170	170	12.5	13.5	233	150	13
80	200	19	160	132	4x22	160	132	8x19	180	280	17	18.5	268	175	16
100	220	19	180	156	8x19	180	156	8x20	190	300	21	22.5	310	200	20
125	250	19	210	184	8x20	210	184	8x21	200	325	29.5	32	357.5	250	25
150	285	19	240	211	8x21	240	211	8x23	210	350	38	41	398.5	300	30
200	340	20	295	266	8x22	295	266	12x23	230	400	58	66	488.5	350	333
250	400	22	350	319	12x23	355	319	12x28	250	450	85.5	100.5	581.5	400	45
300	455	24.5	400	370	12x24	410	370	12x28	270	500	121	141	656.5	500	50
*300	520	26.5	460	429	16x23	470	429	18x28	290	550	144	166	656.5	500	50

* Bore dimension 300mm

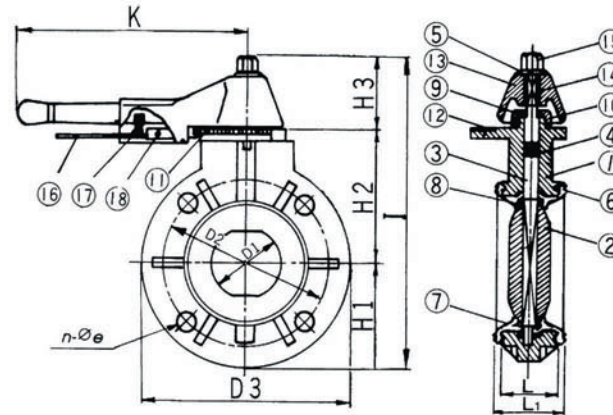

Material List :

Item	Part	Pcs	Materials	Item	Parts	Pcs	Materials
1	Body	1	UPVC,PP,PPG,PVD	10	Reatainer cap	1	UPVC,PP
2	disc	1	UPVC,PP,PPG,PVD	11	Positioner	1	SUS304 8" Use SS41
3	Stem	1	SUS410,SUS316	12	Screw	3	SUS304
4	Stem O'ring	2	EPDM VITON	13	Handle	1	ABS
5	Washer	1	SUS304	14	Inserted Heatal of Handle	1	FC0208
6	Seat	1	EPDM VITON	15	Nut	1	PVC COATED BRASS, SUS304
7	Disc O'ring(1)	2	EPDM VITON	16	Handle Lever	1	SUS 304 8" USE SS41
8	Disc O'ring(2)	2	EPDM VITON	17	Spring	1	SUS304
9	Stem Retainer	1	SUS304	18	Set pin	1	BSBM

Butterfly Lever Handle Type

JSV

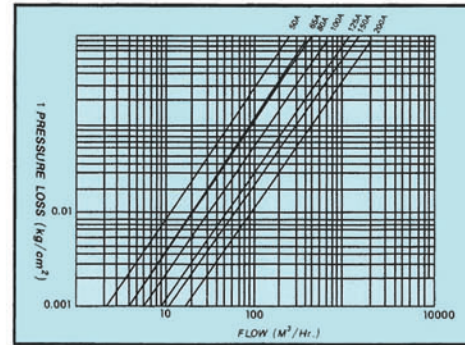
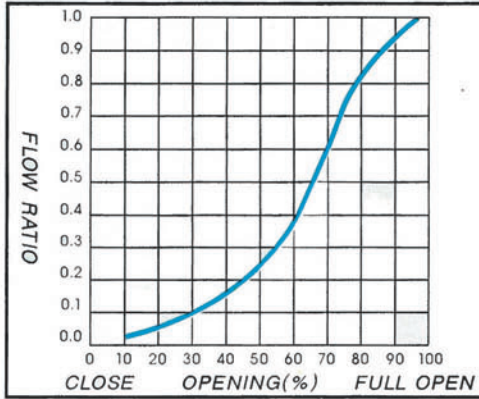

Dimensions :

Nom. Size DN-Inch	D1	D2	D3	ø e	n	L	L1	H1	H2	H3	I	K	Test Press (kgf/cm ²)		Working Press (kgf/cm ²)
													Unit = mm		
													Body	Seal	
50-2"	57	120	160	19	4	35	42	83	102	68	250	220	15	12	10
65-2 1/2"	72	140	184	19	4	37	46	92	110	68	270	220	15	12	10
80-3"	80	150	200	19	8	37	46	100	118	68	286	220	15	12	10
100-4"	100	175	230	19	8	47	56	115	134	68	317	220	15	12	10
125-5"	130	210	250	23	8	57	66	127	160	96	318	310	15	12	10
150-6"	150	240	290	23	8	62	71	145	177	96	418	310	15	12	10
200-8"	203	290	337	23	12	76	87	168	204	93	465	414	15	12	10



Dimensions :

Nom. Size DN-Inch	ANSI												Unit: Inch		
	D1	D2	D3	Ø e	n	L	L1	H1	H2	H3	I	K	Test Press (lb/in ²)		Working Press (lb/in ²)
	Body	Seal													
50-2"	2.24	4.75	6.29	0.75	4	1.38	1.65	3.27	4.01	2.68	9.84	8.66	222	177	150
65-2 1/2"	2.83	5.5	7.24	0.75	4	1.46	1.81	3.62	4.33	2.68	10.63	8.66	222	177	150
80-3"	3.15	6	7.87	0.75	4	1.46	1.81	3.94	4.64	2.68	11.26	8.66	222	177	150
100-4"	3.93	7.5	9.06	0.75	8	1.85	2.2	4.53	5.28	2.68	12.48	8.66	222	177	150
125-5"	5.12	8.5	98.84	0.87	8	2.24	2.6	5	6.3	3.78	15	12.2	222	177	150
150-6"	5.9	9.5	11.42	0.87	8	2.44	2.8	5.71	6.97	3.78	16.46	12.2	222	177	150
200-8"	7.99	11.75	13.27	0.87	8	2.99	3.43	6.61	8.03	3.66	18.31	16.3	222	177	150

Dimensions :

Nom. Size DN-Inch	DIN												Unit: mm		
	D1	D2	D3	Ø e	n	L	L1	H1	H2	H3	I	K	Test Press (kgf/cm ²)		Working Press (kgf/cm ²)
	Body	Seal													
50-2"	57	125	160	18	4	35	42	83	102	68	250	220	15	12	10
65-2 1/2"	72	145	184	18	4	37	46	92	110	68	270	220	15	12	10
80-3"	80	160	200	18	8	37	46	100	118	68	286	220	15	12	10
100-4"	100	180	230	18	8	47	56	115	134	68	317	220	15	12	10
125-5"	130	210	250	18	8	57	66	127	160	96	381	310	15	12	10
150-6"	150	240	290	23	8	62	71	145	177	96	418	310	15	12	10
200-8"	203	295	337	23	8	76	87	168	204	93	465	414	15	12	10



Two Piece Ball Valve JIS10K

JSV

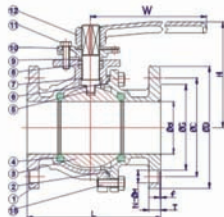

Features :

- ✓ Face to face dimensions : JIS B2002
- ✓ End flange dimensions : JIS B2239
- ✓ Design : ANSI 16.34, Test : API 598
- ✓ Investment casting body
- ✓ Blowout proof stem/hullport
- ✓ Lever/Gear operated
- ✓ With ISO 5211 mounting pad

Material :

- ✓ Cast Iron / FC20
- ✓ Stainless Steel 304 / SCS13
- ✓ Carbon Steel / SCPH2 / WCB
- ✓ Stainless Steel 316 / SCS14



Material List :

NO	PART NAME	MATERIALS			
1	BODY	FC20	WCB	SCS13	SCS14
2	CAP	FC20	WCB	SCS13	SCS14
3	BALL	SS304	SS304	SS304	SS316
4	SEAT	PTFE			
5	STEM	SS304	SS304	SS304	SS316
6	GASKET	PTFE			
7	THRUST WASHER	PTFE			
8	PACKING	PTFE			
9	STEM PACKING	PTFE			
10	GLAND	SCS13			
11	GLAND BOLT	ASTM194-88			
12	HANDLE	FC			
13	STOPPER	SS304			
14	SNAP RING	SS304			
15	BOLT	ASTM194-88			

Test Pressure :

SEAT	BY WATER	BY AIR
SHELL(BY WATER)	450PSI	450PSI
	32kg/cm ²	32kg/cm ²
BY WATER	300PSI	300PSI
	21kg/cm ²	21kg/cm ²
BY AIR	82PSI	82PSI
	6kg/cm ²	6kg/cm ²

Dimensions :

SIZE	#	D	C	G	F	T		N	M	L	H	K	Ma	W	ISO-5211
						FC	SS13								
1/2"	15	95	70	51	1	16	12	4	15	110	85	42	M5	160	F04
3/4"	20	100	75	56	1	18	14	4	15	130	90	42	M5	160	F04
1"	25	125	90	67	1	18	14	4	19	130	100	42	M5	160	F04
1-1/4"	32	135	100	76	2	20	16	4	19	140	105	50	M6	160	F05
1-1/2"	40	140	105	81	2	20	16	4	19	165	110	70	M8	206	F07
2"	50	155	120	96	2	20	16	4	19	180	120	70	M8	206	F07
2-1/2"	65	175	140	116	2	22	18	4	19	190	160	70	M8	324	F07
3"	80	185	150	126	2	22	18	8	19	200	170	102	M10	324	F10
4"	98	210	175	151	2	24	18	8	19	230	185	102	M10	324	F10
5"	115	250	210	182	2	24	20	8	23	300	260	125	M12	650	F12
6"	130	180	240	212	2	26	22	8	23	340	280	125	M12	650	F12
8"	158	330	190	262	2	26	22	12	23	450	340	125	M12	850	F12
10"	250	400	355	324	2	30	24	12	25	530	400	140	M16	3000	F14
12"	300	445	400	368	3	32	24	16	25	610	400	140	M16	3000	F14
14"	350	490	445	413	3	34	26	16	2f	686	400	140	M16	3000	F14

Features :

- ✓ FACE TO FACE DIMENSIONS: ANSI B16.10
- ✓ END FLANGE DIMENSIONS: ANSI B16.5
- ✓ DESIGN: ANSI 16.34
- ✓ TEST: API 598
- ✓ INVESTMENT CASTING BODY
- ✓ BLOW-OUT PROOF STEM/FULL PORT
- ✓ LEVER OPERATED OR GEAR OPERATED WITH ISO 5211 MOUNTING PAD

Material

- ✓ CAST IRON / A126Gr-FC20
- ✓ CARBON STEEL / A216Gr-WCB
- ✓ SS 304 / A351Gr-CF8
- ✓ SS 316 / A351Gr-CF8M

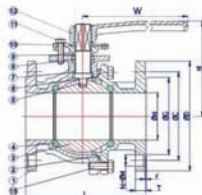
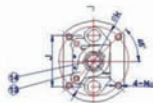

Test Pressure :

SEAT	SHELL (BY WATER)	
		450PSI 32kg/cm ²
	BY WATER	
	80PSI 6kg/cm ²	115PSI 8.2kg/cm ²
	BY AIR	
	80PSI 6kg/cm ²	115PSI 8.2kg/cm ²

Material List :

NO	PART NAME	MATERIALS			
1	BODY	FC20	WCB	CF8	CF8M
2	CAP	FC20	WCB	CF8	CF8M
3	BALL	SS304	SS304	SS304	SS316
4	SEAT	PTFE			
5	STEM	SS304	SS304	SS304	SS316
6	GASKET	PTFE			
7	THRUST WASHER	PTFE			
8	PACKING	PTFE			
9	STEM PACKING	PTFE			
10	GLAND	SS304			
11	GLAND BOLT	ASTM194-B8			
12	HANDLE	FC			
13	STOPPER	SS304			
14	SNAP RING	SS304			
15	BOLT	ASTM194-B8			

Dimensions :

SIZE	d	D	C	G	F	T		N	M	L	H	J	K	Ma	W	ISO 5211
						FC	SUS									
1/2"	15	89	60.5	35	1.6	11.1	11.1	4	16	108	85	50	42	M5	160	F04
3/4"	20	98	70	43	1.6	12.7	11.1	4	16	117	90	50	42	M5	160	F04
1"	25	108	79.5	51	1.6	14.3	11.1	4	16	127	100	50	42	M5	160	F04
1-1/4"	32	117	89	64	1.6	14.9	12.7	4	16	140	105	50	50	M6	160	F05
1-1/2"	40	127	98.5	73	1.6	17.5	14.3	4	16	165	110	62	70	M8	206	F07
2"	50	152	120.5	92	1.6	19.1	15.9	4	19	178	120	62	70	M8	206	F07
2-1/2"	65	178	139.5	105	1.6	22.3	17.5	4	19	190	160	75	70	M8	324	F07
3"	80	190	152.5	127	1.6	23.9	19.1	4	19	203	170	75	102	M10	324	F10
4"	98	229	190.5	157	1.6	23.9	23.9	3	19	229	185	75	102	M10	324	F10
5"	125	254	216	186	1.6	23.9	23.9	8	22	254	200	89	125	M12	650	F12
6"	150	279	241.5	216	1.6	25.4	25.4	8	22	294	180	89	125	M12	650	F12
8"	198	343	298.5	270	1.6	28.6	28.6	8	22	357	240	100	125	M12	850	F12
10"	250	406	362	324	1.6	30.2	30.2	12	25	533	400	100	140	M16	1000	F14
12"	300	483	432	381	1.6	31.8	31.8	12	25	650	480	100	140	M16	1000	F14
14"	350	533	476.5	413	1.6	35	35	12	25	688	480	100	140	M16	1000	F14

- ✓ GGG40 is standard – 3 layer coating EPOXY/EPOXY/PUR, 160 µ.
- ✓ Types: wafer, lug and double flange.
- ✓ Multi-standard alignment holes suitable for mounting flanges:
 DN40 – DN300 wafer type:
 EN1092 PN6, PN10, PN16 – ANSI150 –
 BS10 TABLE D, TABLE E, JIS 10K, 16K
- DN350 – DN600 wafer type:
 EN1092 PN6, PN10, PN16 – ANSI150 – BS10 TABLE D.
- DN40 – DN150 lug type:
 EN1092 PN10, PN16 or ANSI 150.
- DN200 – DN600 lug type:
 EN1092 PN10, PN 16 or ANSI 150.
- Mounting bolts lug: PN = Metric and ANSI = UNC.

- ✓ ISO 5211 top flange according to valve torque
- ✓ Relief track on the ISO top mounting flange

- ✓ A unique dynamic valve line rubber seat provides a highly efficient seal.
- ✓ Reduced torque.
- ✓ Extended sealing life span.
- ✓ Making automation a very price competitive
- ✓ On the wafer type the seat is vulcanized to a phenolic back-up ring – a replaceable construction – on the lug type the seat is vulcanized onto the body.
- ✓ Simple seat replacement.
- ✓ 100% tightness at full differential pressure (PN16 = 16 bar from DN40 – DN50, PN10 = 10 bar from DN200 – DN600).
- ✓ Ideal for full vacuum applications.
- ✓ Trouble-free mounting between flanges.
- ✓ Disc with two-piece shaft construction which enhances the Cv values of the valve and reduces turbulence.

- ✓ The shape and finishing of the edge of the disc, provides the lowest possible operating torque with bubble-tight shut-off, even at maximum operating pressure, thus extending the life span of the valve.



BUTTERFLY

Wafer Type Valve



DN	NPS	A	B	C	D	E	F	G	H	ISO 5211	K	L	M	n	MASS kg
50	2"	50	100	43	63	118	12	34	10	F07	30	90	9	4	2.6
65	2½"	60	115	46	71	126	12	34	10	F07	30	90	9	4	3.2
80	3"	80	130	46	78	133	12	34	10	F07	30	90	9	4	3.5
100	4"	100	150	52	98	147	12	34	12	F07	30	90	9	4	4.5
125	5"	125	182	56	109	160	12	34	12	F07	30	90	9	4	6.3
150	6"	150	210	56	133	180	14	34	16	F07	30	90	9	4	8.8
200	8"	200	262	60	158	204	14	34	16	F07	30	90	9	4	13.2
250	10"	250	315	68	194	245	15	45	24	F10	102	125	11	4	22
300	12"	300	371	78	218	270	15	45	24	F10	102	125	11	4	32
350	14"	358	405	78	256	315	15	45	24	F10	102	125	11	4	40

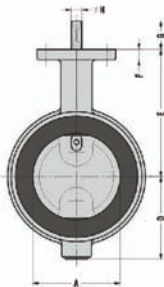
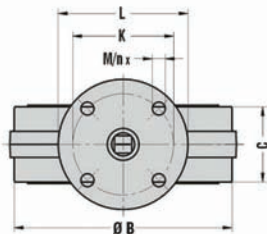

DN	NPS	A	B	C	D	E	F	G	H	ISO 5211	K	L	M	n	MASS kg
400	16"	386	470	102	308	363	25	30	30	F14	140	175	17	4	75
450	18"	438	522	114	334	388	25	30	30	F14	140	175	17	4	90
500	20"	486	576	127	360	413	25	30	30	F14	140	175	17	4	120
600	24"	586	672	154	426	510	25	30	40	F14	140	175	17	4	180
700	28"	686	776	185	480	560	25	60	46	F16	165	210	21	4	295
750	30"	736	826	190	520	585	25	60	46	F16	165	210	21	4	295
800	32"	786	880	190	525	610	25	60	46	F16	165	210	21	4	345
900	36"	886	980	203	635	690	30	90	60	F25	254	350	17	8	475
1000	40"	986	1085	216	685	740	30	90	60	F25	254	350	17	8	635
1000	40"	986	1085	216	685	740	30	90	60	F30	298	350	21	8	635

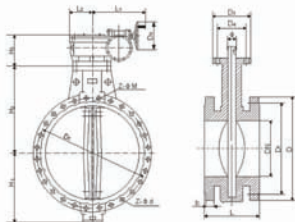

Features :

- ✓ High Quality Water Works Valve
- ✓ Fusion Bonded Epoxy Coated Ductile Iron Body
- ✓ 1,600kPa rating
- ✓ 316SS slim-style disc
- ✓ One Piece Stainless Steel shaft supported by 4 bronze bushes
- ✓ Proven full length wrap around seat
- ✓ Face to face dimensions to AS4795/ISO-5752
- ✓ Stainless Steel fasteners

Dimensions :

DN Nominal Diameter	Size (mm)													
	L	L1	D		D1		D2	D4	H1	H2	H3	h	z-Ød	
50	108	160	165	165	125	125	77	57	83	130	60	18	4-18	4-18
65	112	160	165	165	145	145	77	57	63	140	60	18	4-18	4-18
80	134	160	200	200	160	160	77	57	100	150	60	20	8-18	8-18
100	127	160	220	220	180	180	92	70	110	165	60	20	8-18	8-18
125	140	160	250	250	210	210	92	70	125	180	60	22	8-18	8-18
150	140	160	285	285	240	240	92	70	145	200	60	22	8-22	8-22
200	152	210	340	340	295	295	115	89	171	230	72	24	8-22	12-22
250	165	210	390	405	350	355	115	89	209	270	72	24	12-22	12-26
300	178	210	440	460	400	410	140	108	230	320	75	26	12-22	12-26
350	190	210	500	520	440	470	140	108	260	350	75	26	16-22	16-26
400	216	320	565	580	515	525	157	119	300	390	126	28	16-26	16-30
450	222	320	615	640	565	585	157	119	335	428	126	30	20-26	20-30
500	229	320	670	715	620	650	157	119	373	450	126	32	20-26	20-33
600	267	340	780	840	725	770	276	216	430	520	127	34	20-30	20-36
700	292	380	895	910	840	840	300	254	470	600	167	36	24-30	24-36
800	318	380	1015	1025	950	950	300	254	523	662	167	36	24-30	24-39
900	330	400	1115	1125	1050	1050	300	254	589	710	193	40	28-33	28-39
1000	430	400	1230	1255	1180	1170	300	254	656	780	193	42	28-36	28-42



PRODUCT DESCRIPTION

Wafer style, uni-directional knife gate valve. One piece integral cast body with guides to support the gate and sealing wedges. High flow rates with low pressure drops. Several seat and packing materials available. Face to face dimension according JSV standard. Arrow in the body pointing the flow direction.

GENERAL APPLICATIONS

This knife gate valve is appropriate for liquids with a solids concentration of maximum 5%.

If it is used for dry solid in gravity feed applications it is recommended to be installed with the arrow in the opposite direction to the flow direction.

Designed for a wide range of applications such us:

- Pulp and Paper.
- Mining.
- Effluent handling plants.
- Chemical plants.
- Food and beverage.
- Bulk conveying.
- Sewage applications.
- Chemical plants.

TECHNICAL DATA

Standard manufacturing size:

From DN50 up to DN1200 (bigger size under request)

Working pressures:

From DN 50 to DN 125: 10 (kg/cm²)

DN 150-8 (kg/cm²)

DN 200: 7 (kg/cm²)

From DN 250 to DN 300: 5 (kg/cm²)

From DN 450 to DN 600-4 (kg/cm²)

From DN 700 to DN 1200-2 (kg/cm²)

Flange connection drillings:

The standard flange connection is according to DIN PN10.

Other flange connection such as, JIS ANSI 150, DIN PN6 - PN16 - PN25, British standard, Australian Standard.

Standard are available under request.

Quality Dossier: all valves are hydrostatically tested at JSV with water and JSV material and test certificates can be provided.

Body test pressure = Maximum rate pressure x 1,5

Seat test pressure = Maximum rate pressure x 1,1

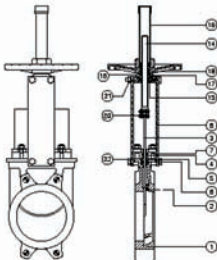

STANDARD MANUFACTURING MATERIALS (OPTIONS 1 AND 2)

POL.	DESCRIPTION	MATERIAL Option 1	MATERIAL Option 2
1	BODY	CG-25	CF8M
2	SUPPORT GUIDES	ROH 1000	ROH3000
3	KNIFE	304	316
4	PACKING GLAND	ALUMINIUM	CF8M
5	PACKING	SYNTEX + PTFE	SYNTEX + PTFE
6	O-RING	EPDM	EPDM
7	STUD	STEEL + ZINC	316
8	SUPPORT PLATES	STEEL	STEEL
9	SEAT RETAINING RING	316	316
10	SEALING JOINT	EPDM	EPDM
11	REINFORCED SOCKET	CF8M	CF8M
12	DEFLECTION CONE	CAST	CAST/CF8M
13	JOINT	BELPA DW	BELPA DW
14	SPINDLE (STEM)	303	303
15	STEM NUT	BRONZE	BRONZE
16	NUT	ST 44.2 + ZINC	ST 44.2 + ZINC
17	YORK	STEEL + ZINC	STEEL
18	HANDWHEEL	NOODULAR IRON	NOODULAR IRON
19	STEM PROTECTION HOOD	STEEL	STEEL
20	BOLTS/NUTS/WASHERS	304	316
21	BOLTS/NUTS/WASHERS	STEEL	STEEL
22	BOLTS/WASHERS	STEEL	316

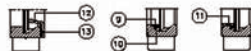

GENERAL DIMENSIONS: CAHINWHEEL-RISING STEM (non rising stem also available)

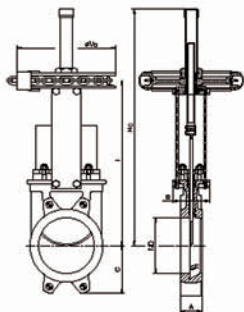

ND	DIMENSIONS					
	A	B	C	F	ØVc	Hc
50	48	92	63	264	266	437
65	48	92	70	291	266	464
80	51	92	92	317	266	490
100	51	92	105	357	266	530
125	57	102	120	390	266	613
150	57	102	130	442	266	665
200	60	119	160	551	266	849
250	70	119	198	652	266	1050
300	76	119	234	752	266	1150
350	76	194	256	879	402	1398
400	89	194	292	985	402	1504
450	89	280	308	1071	402	1690
500	114	280	340	1183	402	1802
600	114	280	400	1389	402	2108
700	117	300	452			
800	117	300	505			

GENERAL DIMENSIONS: PNEUMATIC DOUBLE ACTING (air supply pressure :6kg/cm²)

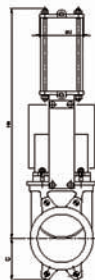

ND	DIMENSIONS						WEIGHT (Kgs.)	
	A	B	C	Ø	S	Hc		
				CYLINDER	B.S.P	J		
50	40	92	63	80	1/4"	96	400	7
65	40	92	70	80	1/4"	96	442	8
80	50	92	92	80	1/4"	96	483	9
100	50	92	105	100	1/4"	115	546	11
125	50	102	120	125	1/4"	138	630	18
150	60	102	130	125	1/4"	138	692	22
200	60	119	160	160	1/4"	175	889	39
250	70	119	196	200	3/8"	218	1032	55
300	70	119	234	200	3/8"	218	1182	69
350	96	280	258	250	3/8"	270	1379	130
400	100	280	292	250	3/8"	270	1535	160
450	108	280	308	300	1/2"	382	1677	221
500	110	280	340	300	1/2"	382	1839	260
600	110	280	400	300	1/2"	382	2145	341
700	110	320	452	350	1/2"	426	2488	556
800	110	320	505	350	1/2"	426	2798	679
900	110	320	555	400	1/2"	538	3162	840
1000	110	320	610	400	1/2"	538	3452	1053
1200	150	400	725	400	1/2"	538	4048	-